

252

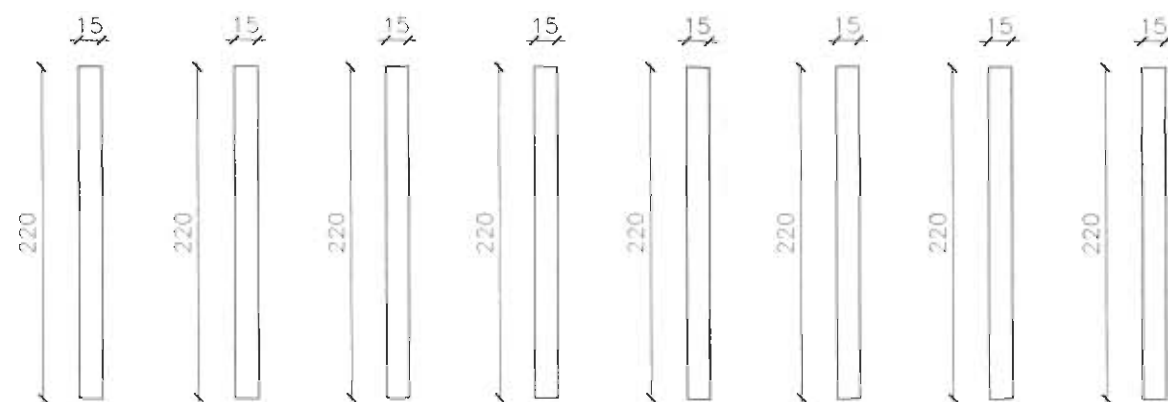

COLUNAS

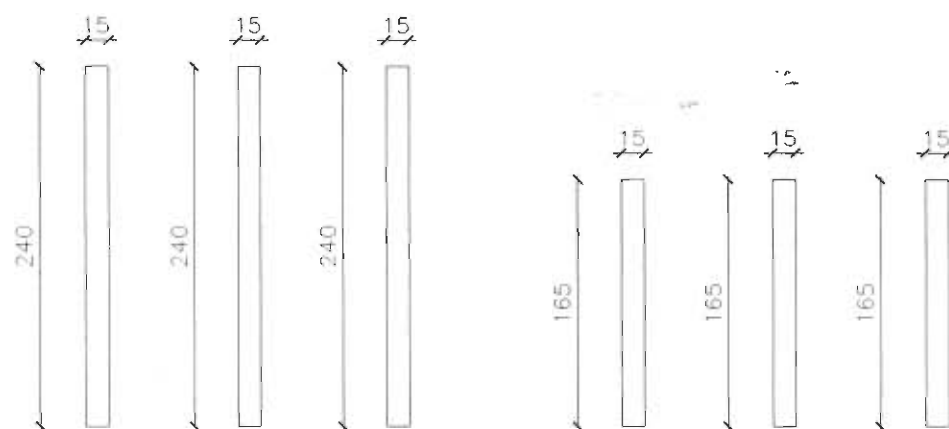

TRAVESSAS

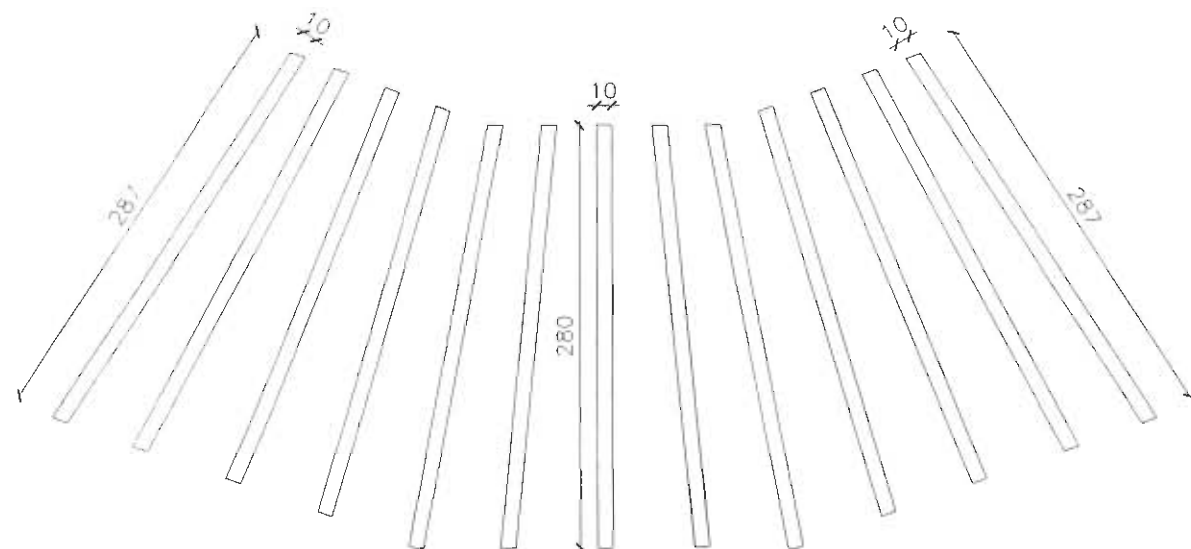

PÉRGOLAS

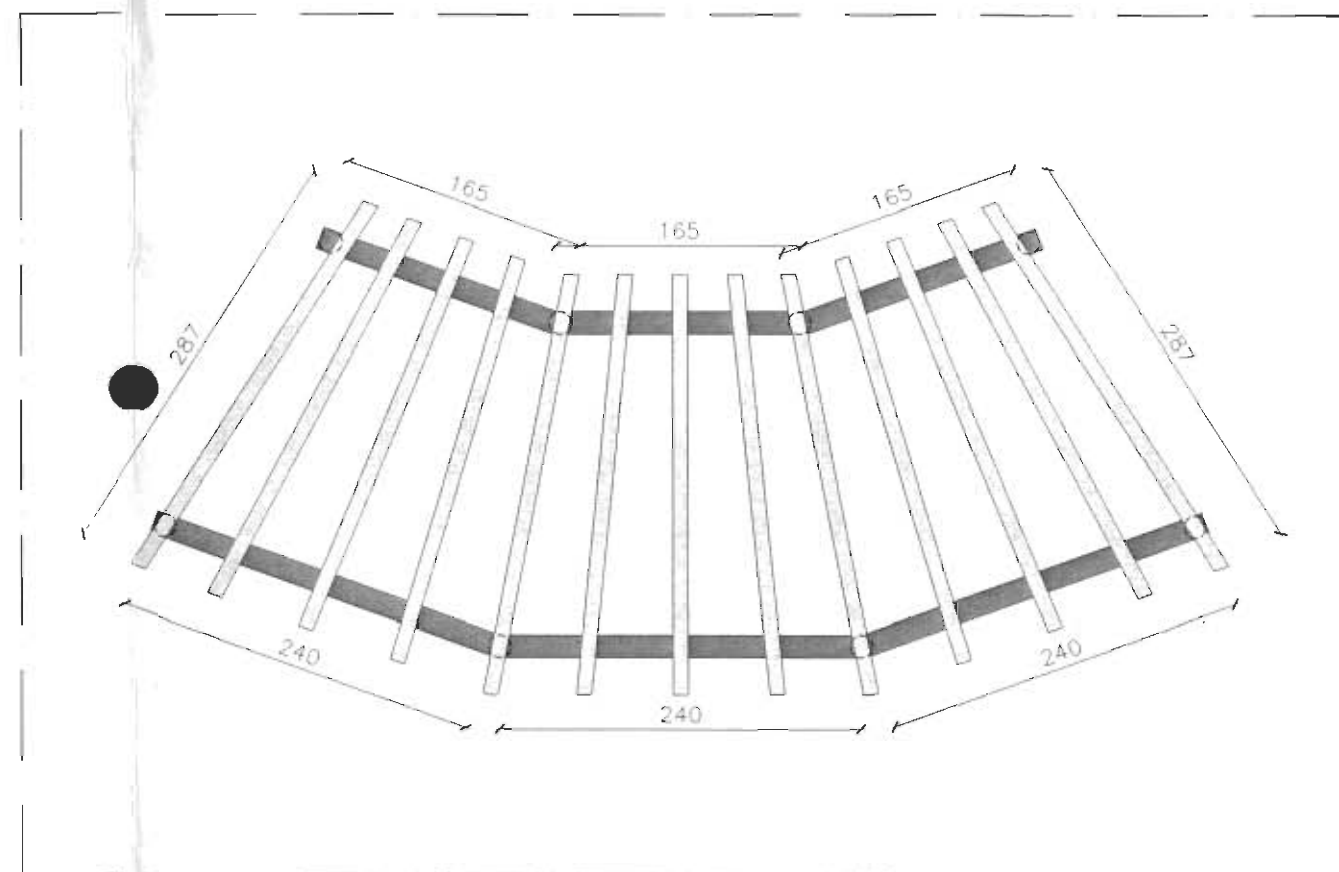

OBSERVAÇÕES.

- COLUNAS 15X15CM
- TRAVESSAS 15X5CM
- PÉRGOLAS 10X5CM



PERGOLADO - PRAÇA SANTO ANTÔNIO
REGIONAL NORTE

PROJETISTA:

Pedro Ernani A. Maciel
PEDRO ERNANI AMARAL MACIEL

DEPARTAMENTO DE COORDENAÇÃO DE MANUTENÇÃO
DAS REGIONAIS

Daniel Garcia Toscano Barreto
DANIEL GARCIA TOSCANO BARRETO

04/12/2019
ESCALA 1/50

01/01
FORMATO: A3